

# On the way to a sustainable city

## Brussels Capital Region low carbon policy



Cabinet of Minister Evelyne Huytebroeck – Environment, energy and urban renovation Minister of Brussels Capital Region



# Objectives

## A commitment taken in 2004

- **Brussels-Capital Region has set itself the objective of reducing its greenhouse gas (GHG) emissions by 30% and by 40%/inhabitant by 2025 compared with 1990.**
- **One of the first to sign the Covenant of Mayors in 2009.**
- **Following its signature, Brussels adopted an Action Plan for a Low-Carbon Brussels Region by 2025.**



# Brussels-Capital Region

## A specific context

- A dense urban Region, made up of 19 municipalities with approximately 1.1 million inhabitants
- Capital of Belgium and Europe, should lead by example
- Legislative autonomy regarding energy skills - bound by international objectives (climate and energy)
- Population has grown fast over the last decade, and is still growing
- Economic heart of Belgium
- Old building stock, 75% of energy consumption by buildings
- Low renewable energy potential

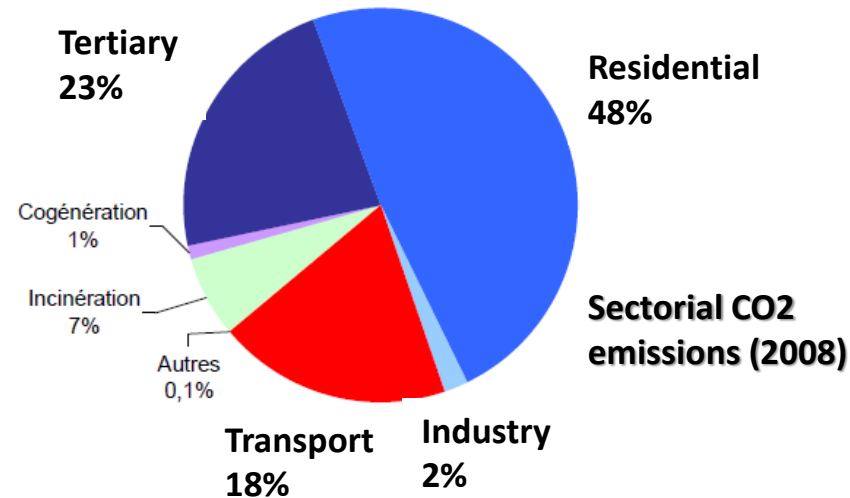
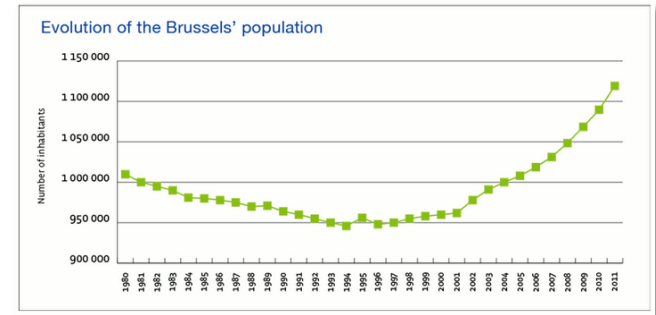

➔ **First target** : building

➔ **Second target** : transport

# A success story starting from scratch

## Step one : stimulate demand

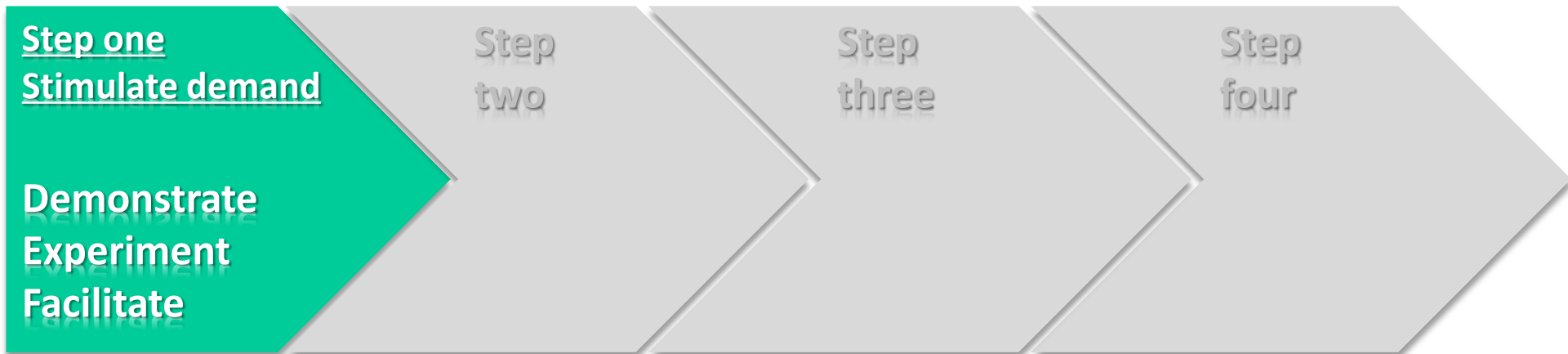

- Energy subsidies
- Social guidance (precarious households)
- Local management action plan (energy management)
- Exemplary buildings (construction/renovation)
- Helping and training experts : visits, testimony, dialogue with sectorial federation

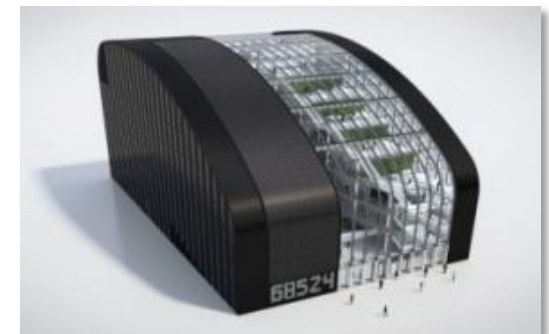

Environment and energy ministry  
new passive building



# A success story starting from scratch

## Step two : Inform



- Campaigns
- Energy challenge (behaviour)



**Douchette économique**  
**€52 PAR AN**

**Economisez l'énergie: la planète en profite autant que votre portefeuille.**

Vous êtes locataire ou propriétaire ? Vos factures d'énergie sont trop lourdes dans votre budget ? En remplaçant vos anciennes douchettes, vous pouvez diminuer le montant de votre facture de 20%.

Les participants au Défi Énergie des années précédentes l'ont prouvé: ils ont économisé jusqu'à 100€ par an !

Comment ? En installant une douchette à 32°C, en installant des tentures aux fenêtres, en dégivrant le réfrigérateur, etc. De petits gestes faciles qui vous rapportent des gains plus importants qu'on ne le croit. Ces économies équivalent à une diminution de votre consommation de CO2.

Inscrivez-vous dès maintenant au Défi Énergie 2010.

**le défi énergie**

Plus d'infos? [www.de-energie.be](http://www.de-energie.be) - 0800 / 85 303  
Chaque geste compte quand on est plus d'un million de Bruxellois.

**BRUXELLES ENVIRONNEMENT**

**LOUER**  
**RÉPARER**  
**RELOOKER**

Pour réduire les déchets, multiplions ces gestes.

**BRUXELLES ENVIRONNEMENT**

INFOS 02 715 75 75 - [WWW.BRUXELLESENVIRONNEMENT.BE](http://WWW.BRUXELLESENVIRONNEMENT.BE)

# A success story starting from scratch

## Step three : Implement

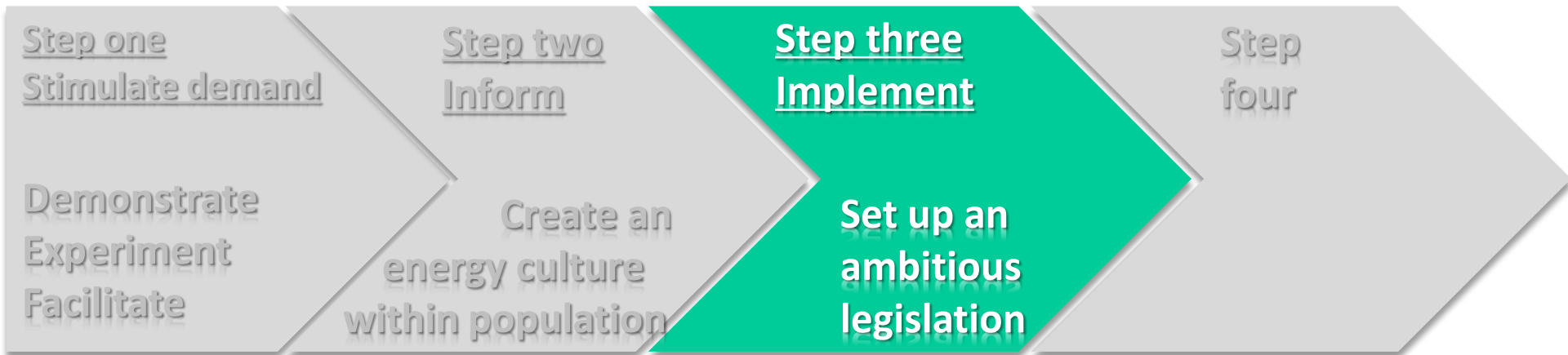

**Thanks to previous work to stimulate demand and exemplary public authorities, an ambitious standard could be developed in consultation with the industry**

- **Mandatory audits for big consumers**
- **Mandatory local management action plan from 100,000m<sup>2</sup>**
- **Energy performance of buildings legislation**

# A success story starting from scratch

## Step four : Stimulate supply

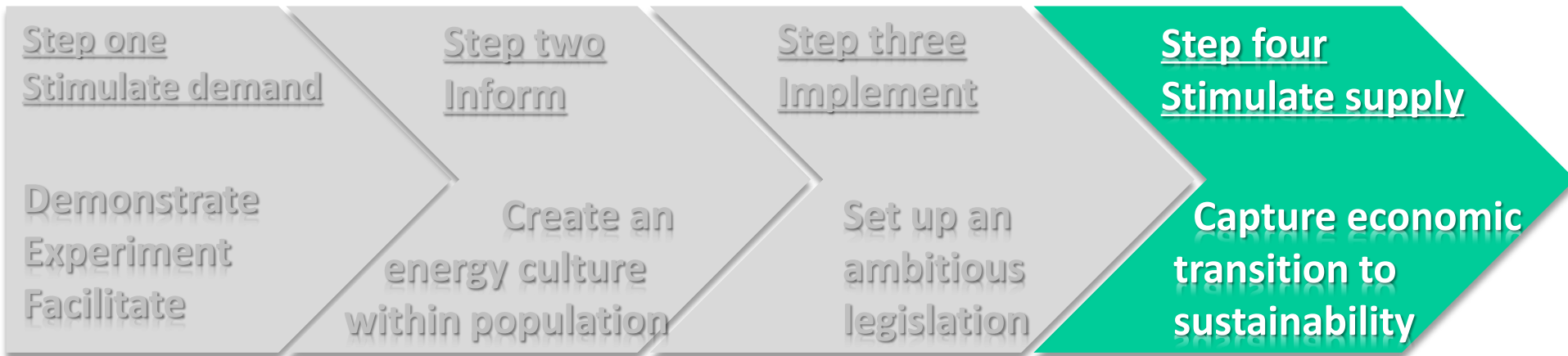

- **Employment-environment alliance – sustainable construction axis 2015**
- **Develop an offering of local businesses in the construction sector capable of responding to the challenge of the new energy ambitions for buildings**
- **Adapt the training offering : workers trained in the new challenges**
- **Multi-sectoral pact between public authorities, sectoral federations and companies, social partners and all those involved in the sector**
- **Creates employment**

# Evolution to passive standard by 2015

## An example of Brussels strategy

**Step one**  
**Stimulate demand**

Step two

Step three

Step four

- Exemplary buildings
- Information
- Financial incentive (€/m<sup>2</sup>)
- Expertise
- Visibility
- Public authorities demonstration

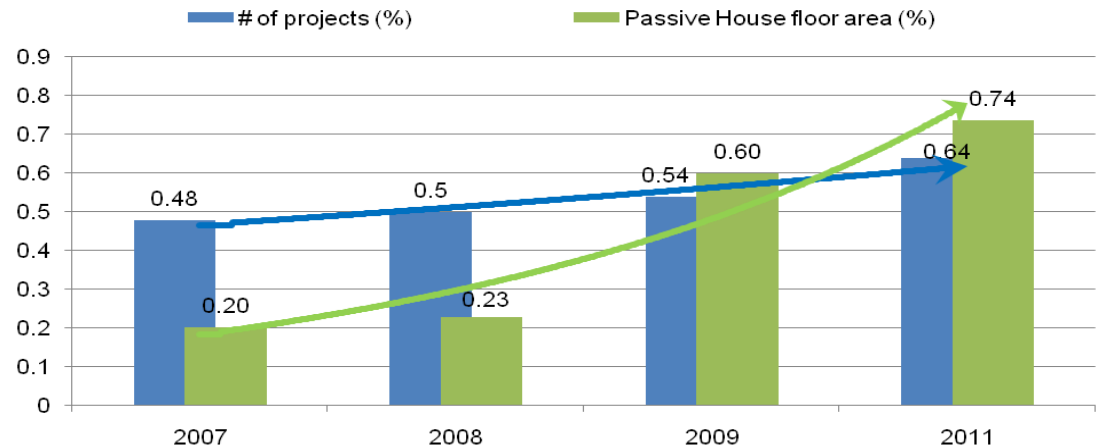

Proportion of Passive House buildings within Exemplary Buildings.



# Evolution to passive standard by 2015

## An example of Brussels strategy

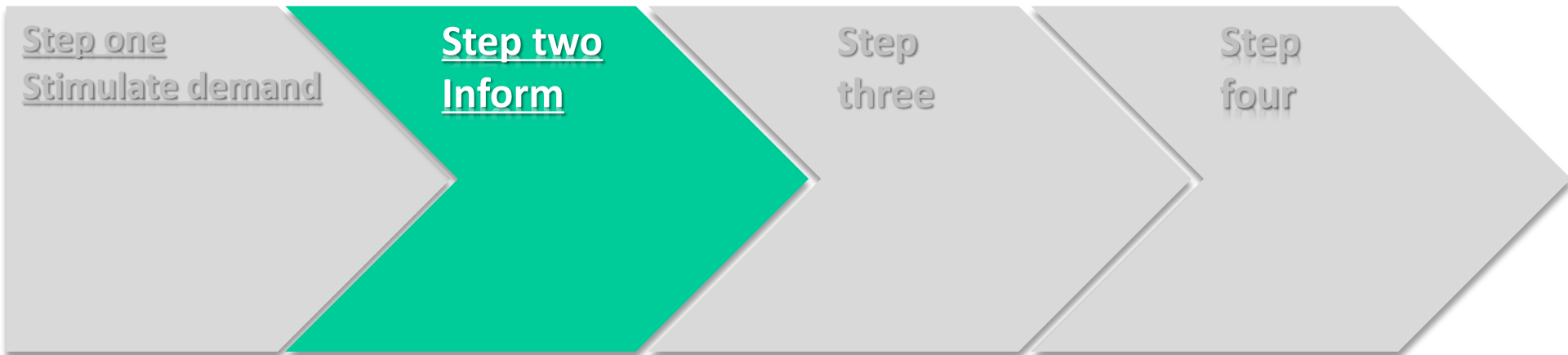

BRUXELLES  
PASSIF !

PASSIF 2015



[ACTUALITÉ](#)

[AGENDA](#)

[OPINIONS](#)

[BÂTIMENTS](#)

[RESSOURCES](#)

NL | FR



Depuis 2007, la Région de Bruxelles-Capitale travaille activement à l'amélioration des prestations énergétiques des bâtiments. Que ce soit par le biais de l'octroi de primes pour les nouvelles constructions et les rénovations, d'appel à projets ou de mise en évidence de bâtiments

exemplaires. Les exemples Bruxellois allient une architecture forte et la gestion durable, liées notamment à l'eau, l'énergie ou le choix des matériaux. Ils démontrent par là qu'un bâtiment avec une empreinte écologique minimale peut aussi être confortable et d'un budget raisonnable.

Ils contribuent ainsi à augmenter la confiance du secteur dans les possibilités de construire de manière durable. La Région est désormais prête à étendre le succès de la formule à des applications plus larges.

**BRUXELLES PASSIF 2015 :**  
**IMPLICATIONS CONCRÈTES**  
**POUR LES ACTEURS**  
**DU MARCHÉ**



L'ACCORD BRUXELLES PASSIF

# Evolution to passive standard by 2015

## An example of Brussels strategy

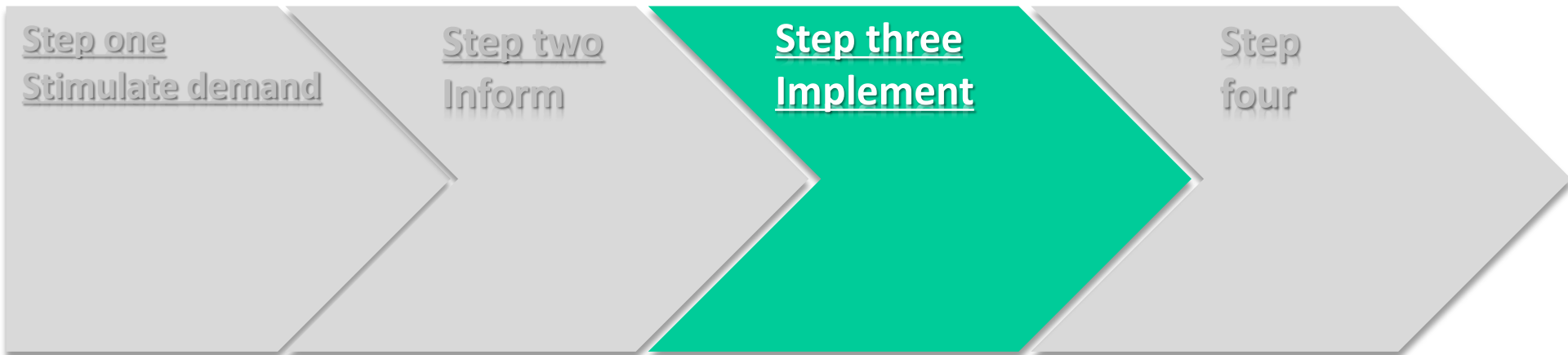

- **Energy performance of buildings legislation**
  - **2010** : passive standard for public buildings constructions  
low energy standard for heavy renovations
  - **2015** : passive standard for all constructions  
low energy standards for heavy renovations



# Evolution to passive standard by 2015

## An example of Brussels strategy

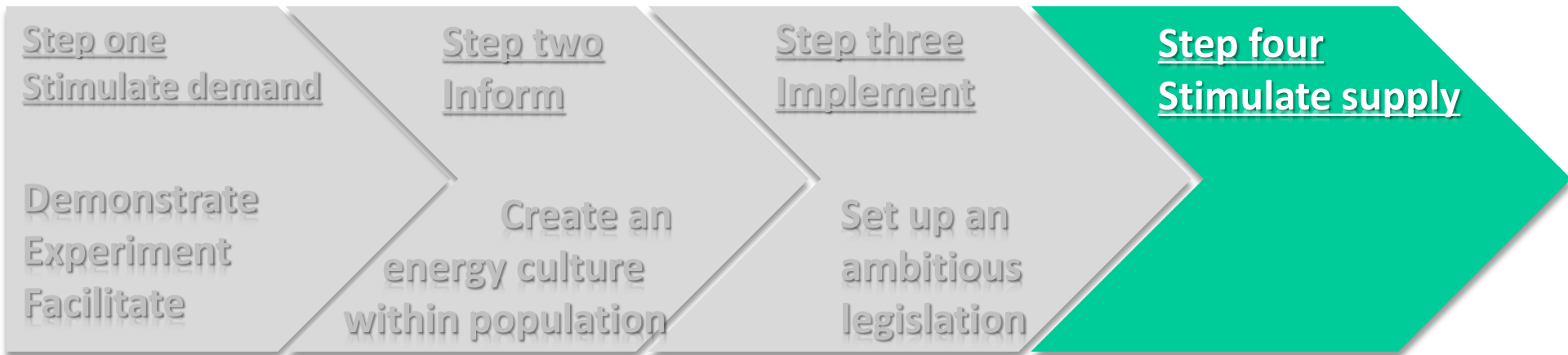

## Final result

- From 0 in 2004 to 520,000m<sup>2</sup> of passive buildings in Brussels by 2015
- Brussels has developed one of the most ambitious energy performance legislations in Europe
- This policy was shown as an example by the European Commission, which awarded the Brussels Region the **Sustainable Energy Award 2012**.

# Brussels building policy

Acting on all steps of building life-cycle

Energy and renovation subsidies  
EPB legislation  
Exemplary buildings

Heavy renovation

Construction

EPB legislation  
Exemplary buildings

Behaviour

Energy challenge  
Energy houses

Building life-cycle

Light renovation

Energy and renovation subsidies  
Green loan

Management

Local action plans  
Mandatory audit

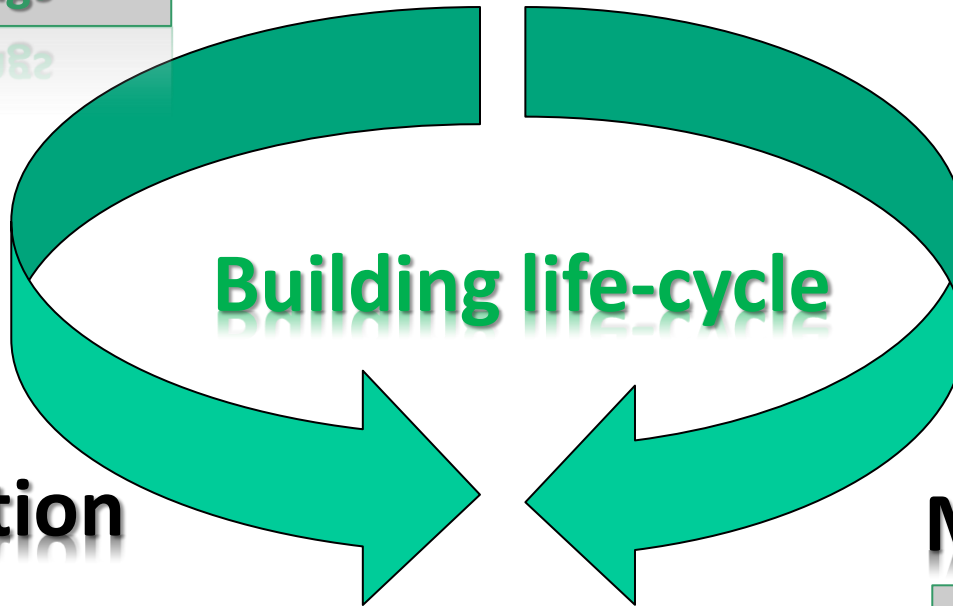

# Second target : transport

## An ambitious objective

**Public transport attendance** (in millions of trips)

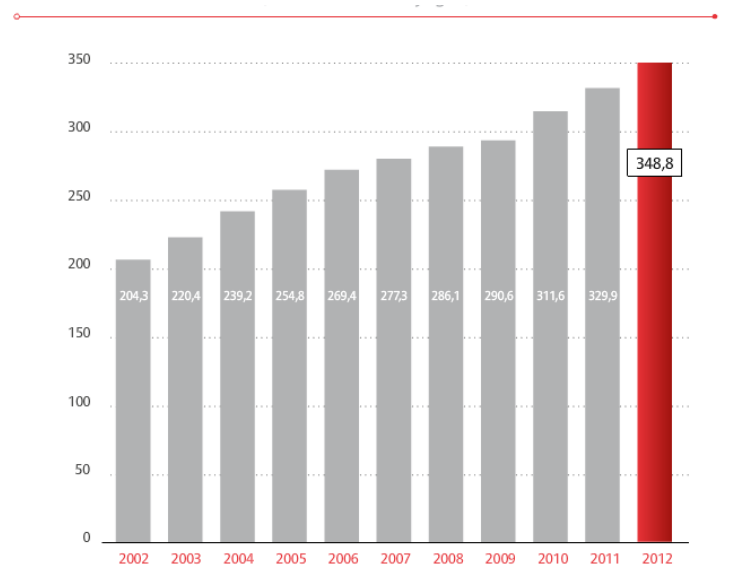

**One objective :** reducing the traffic of 20% between 2001 and 2018

**One priority :** public transport

## Results

	1999	2010
Car	49.6%	32.0%
Train	0.2%	0.9%
Public transport	14.5%	25.0%
Walk	32.6%	37.0%
Bike	1.2%	3.5%
Other	1.9%	1.6%

Modal shift between 1999 and 2010





# Results

Evolution of energy consumption/inhabitant in Brussels (reference year = 1990)

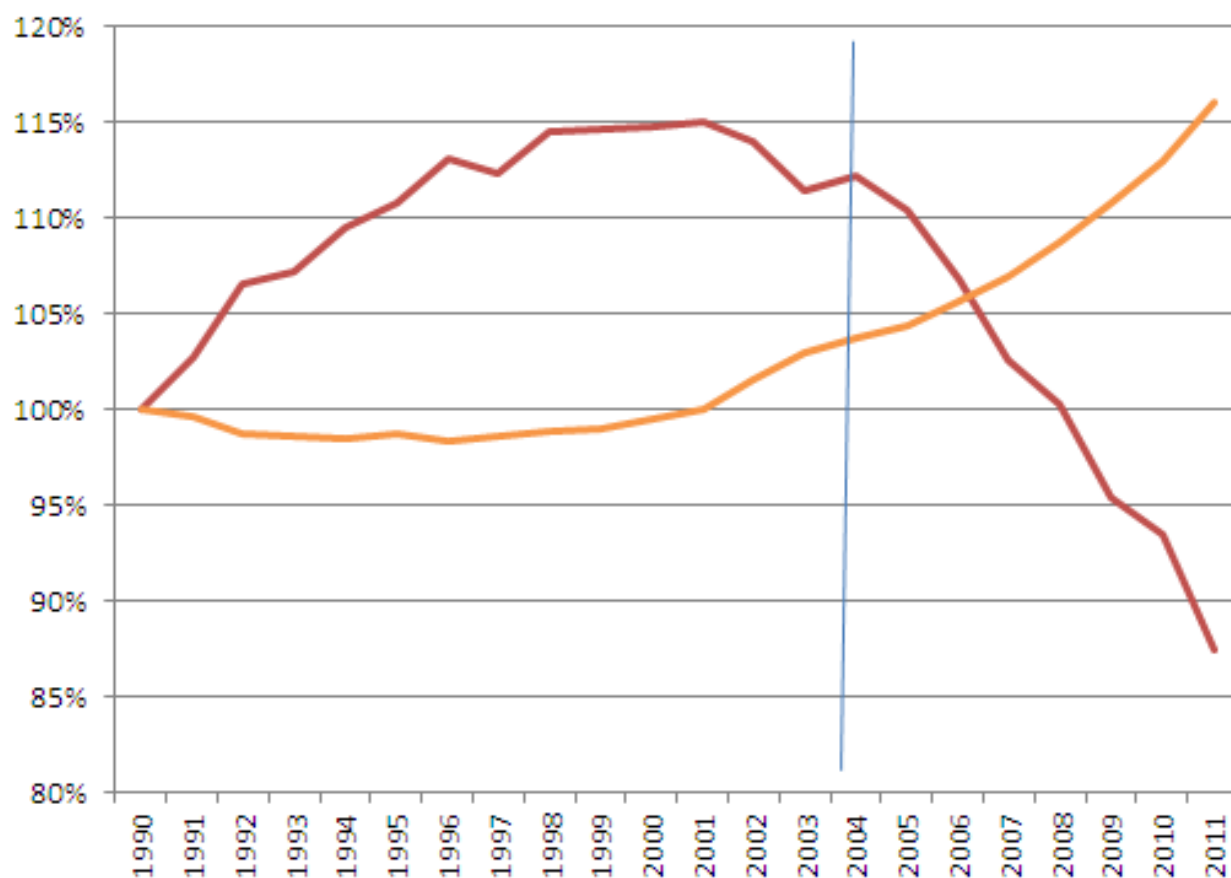

## Energy consumption

1990 - 2011 : - 13 %  
1990 - 2004 : + 12 %  
2004 - 2011 : - 25 %

## Population

1990 - 2011 : +16%  
1990 - 2004 : +4%  
2004 - 2011 : +12%

# Results

Evolution of real greenhouse gases emissions since 1990 in Brussels

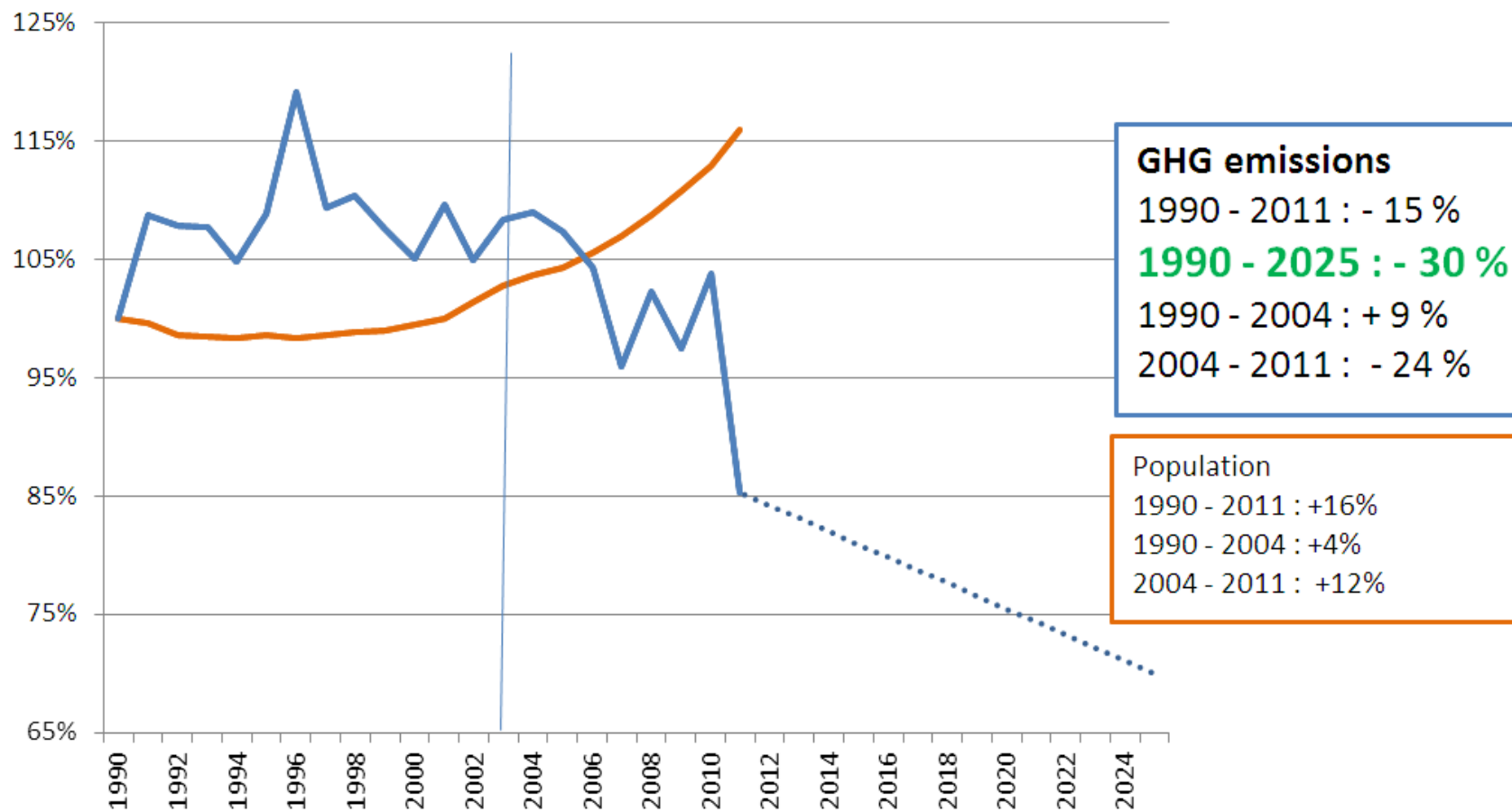



**Cabinet of Minister Evelyne Huytebroeck – Environment, energy and urban renovation Minister of Brussels Capital Region**

Tél: +32 (0)2 517 14 39

[www.evelyne.huytebroeck.be](http://www.evelyne.huytebroeck.be)



**Evelyne Huytebroeck, Brussels Capital Region Minister of Environment, Energy and urban Renovation**